

DIMENSIONS

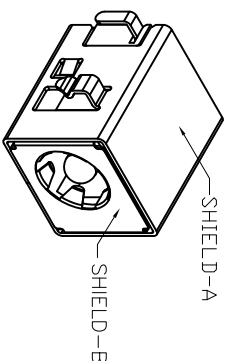

- MODEL CODE:  
DCT0-085DHS-A □ 10 BK S 0 1
- (1) Series type: SMD DC POWER JACK.  
(2) Series No.  
(3) Schematic option: A  
(4) Center pin diameter:  
H=φ2.0mm, J=φ2.5mm  
(5) Material of housing:  
10=PA10T  
(6) Housing color:  
BK=Black  
(7) Terminal plating:  
S=Silver(Ag)  
(8) Special option:  
0=No special option  
(9) Packing mode:  
1=Reel packing

- Specification:  
1. Rating : 5A/16V DC Max.  
2. Contact resistance: ≤30mΩ  
3. Insulation resistance: ≥100MΩ (DC500V),  
After test: ≥50MΩ  
4. Withstanding voltage: 500VAC.  
5. Insertion and extraction force: 0.3~3Kgs.  
6. Life test: 5,000cycles min.  
7. Operation temperature range: -25℃~85℃.

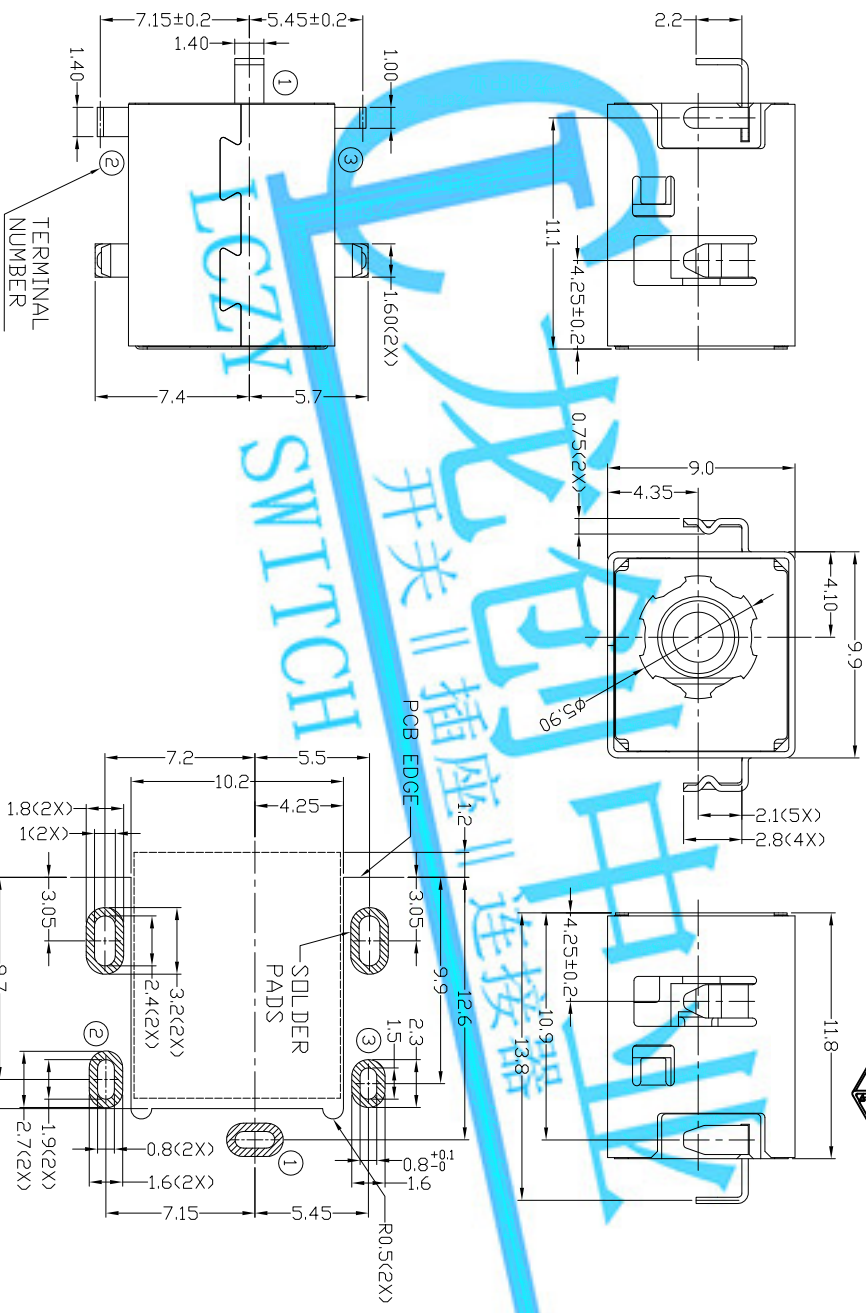
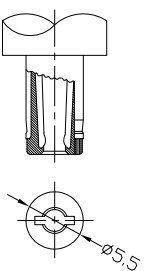
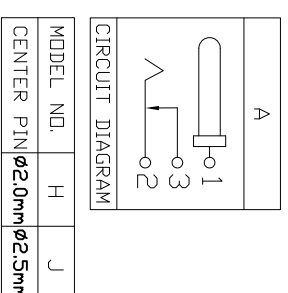

DC MATE PLUG

RECOMMENDED P.C.B. LAYOUT  
TOLERANCE: ±0.05  
(TOP VIEW)

Bill of materials:

NO.	PARTS	MATERIAL	Q'TY	FINISHING	UNIT'S	mm	SCALE	REV.	CUSTOMER DRAWING
7	CENTER PIN	BRASS	1	NICKEL PLATED					
6	TERMINAL 1	BRASS	1	SILVER PLATED	±0.3				
5	TERMINAL 2	COPPER ALLOY	1	SILVER PLATED	±2°				
4	TERMINAL 3	BRASS	1	SILVER PLATED					
3	SHIELD-A	BRASS	1	NICKEL PLATED					
2	SHIELD-B	STAINLESS STEEL	1						
1	HOUSING	PA10T	1	UL94V-0					

LONGCHUANG ZHONGYE (HK)CO.,LIMITED

MODEL NO.: DCT0-085DHS  
PART NO.:  
SMD DC POWER JACK

DR: Steady 2018/10/08  
CHKD: Steady 2018/10/08  
DWG NO.: AT0-085DHS  
SCALE SHEET 1/1  
REV. A  
APPD:

REV.	ECN.	NO.	APPD.